

Single in-line ATC fuseholder

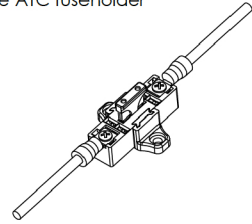

1 x in/ 3 x out fused distribution block

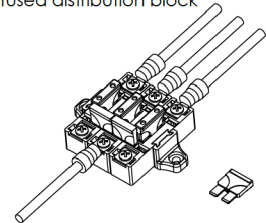

ATMFP

ATC/ATM STACKABLE FUSE PANEL



SALES 386-257-2956

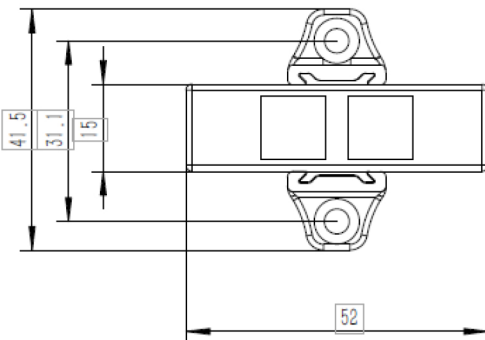
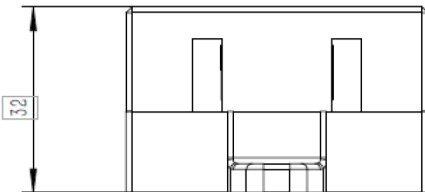

PRODUCT OVERVIEW

Modular ATC fuse block is ideal for marine and vehicle electrical systems. It is not only an in-line fuse holder, with jumpers you can use it to create any distribution block, fused distribution block or power/ground block as you want.

- **Maximum Amperage:** 40A per circuit / 100A per block
- **Maximum Voltage:** 32V DC
- **Mounting:** #8 Screw (M4)
- **Positive/Negative Bus:** #10-32 stud
- **Screw Terminal Torque:** 15 in-lb (1.69 N.m)
- **Screw Terminal Type:** #8-32 screws with star lock washer
- **Note:** Fuse not included



WARNING:
Cancer and Reproductive Harm
www.P65Warnings.ca.gov