



Fits Kia Soul (with NAV) 2014-2019

Visit MetraOnline.com for more detailed information about the product and up-to-date vehicle specific applications

KIT FEATURES

- ISO DIN radio provision with pocket
- ISO DDIN radio provision
- Includes climate display for fan speed, mode, and temp, which was displayed on the factory radio
- Includes an Axxess interface and wiring harness
- Includes an AX-CAM6V and antenna adapter for a complete installation
- Painted high gloss black

KIT COMPONENTS

- A) Radio/climate trim panel with climate display
- B) Radio brackets
- C) Pocket
- D) Heated seat blank plugs
- E) (4) #8 x 3/8" Phillips screws
- F) (6) Panel clips
- **Not shown:** Axxess interface and wiring harness

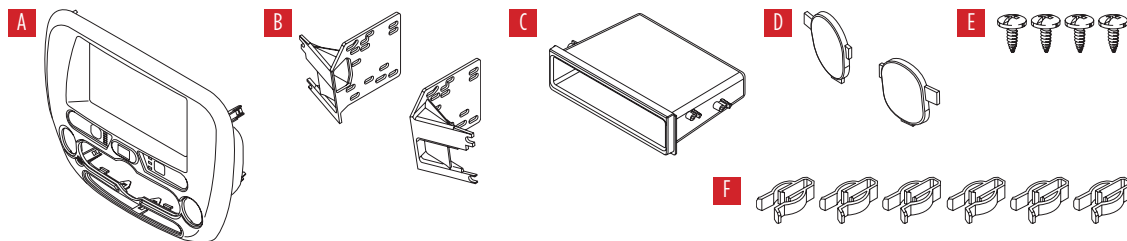

TABLE OF CONTENTS

Dash Disassembly.....	2
Kit Preparation.....	2
Kit Assembly	
–ISO DIN radio provision with pocket.....	3
–ISO DDIN radio provision.....	3
Axxess Interface Installation	4-11

WIRING & ANTENNA CONNECTIONS (Included with kit)

- Wiring harness
- Antenna adapter
- Steering wheel control interface
- 12v to 6v camera step-down

TOOLS REQUIRED

- Panel removal tool
- Phillips screwdriver

Attention! With the key out of the ignition, disconnect the negative battery terminal before installing this product. Ensure that all installation connections are secure before cycling the ignition to test this product.

DASH DISASSEMBLY

1. Unclip the climate panel surrounding the radio and set to the side. (Figure A)
2. Remove (4) Phillips screws securing the radio. Slide the radio out, then unplug and remove the radio. (Figure B)

Continue to Kit Preparation

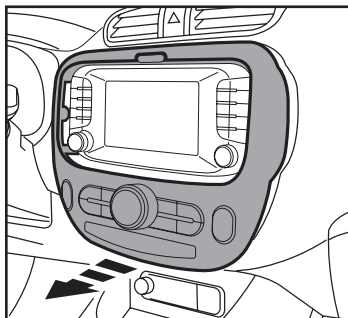

(Figure A)

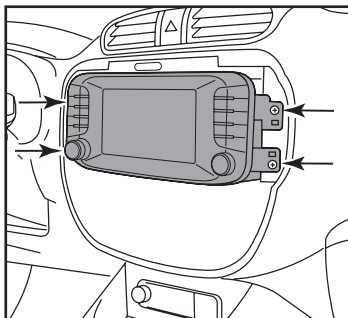

(Figure B)

KIT PREPARATION

From the factory climate panel:

1. Remove (4) Phillips screws securing the climate controls and passenger airbag switch panel, then remove the components. (Figure A)

To the 99-7388HG radio/climate trim panel with climate display:

2. If the vehicle is not equipped with heated seats, snap in the heated seat blank plugs. (Figure B)
3. Secure the climate controls and passenger airbag switch panel using the factory screws. (Figure C)

Continue to Kit Assembly

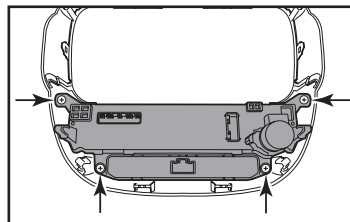

(Figure A)

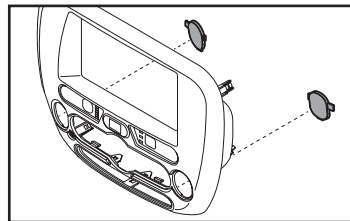

(Figure B)

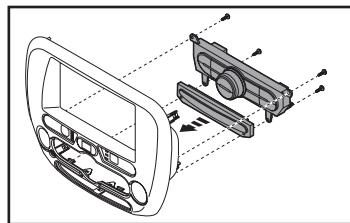

(Figure C)

KIT ASSEMBLY

ISO DIN radio provision with pocket

1. Secure the *radio brackets* to the *pocket* using the (4) #8 x 3/8" Phillips screws provided. (Figure A)
2. Remove the metal DIN sleeve and trim ring from the aftermarket radio.
3. Slide the radio into the bracket/pocket assembly, then secure it to the assembly using the screws supplied with the radio. (Figure B)

Continue to Axxess Interface Installation

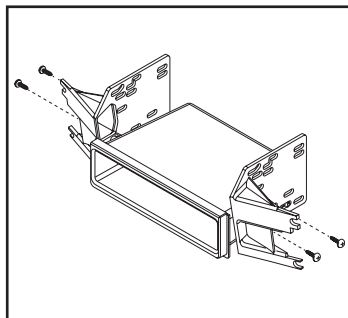

(Figure A)

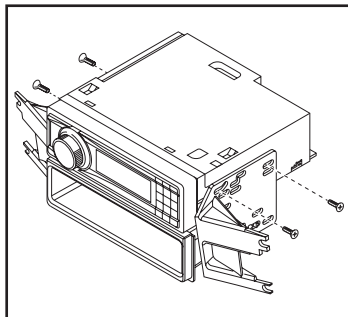

(Figure B)

ISO DDIN radio provision

1. Secure the *radio brackets* to the radio using the screws supplied with the radio. (Figure A)

Continue to Axxess Interface Installation

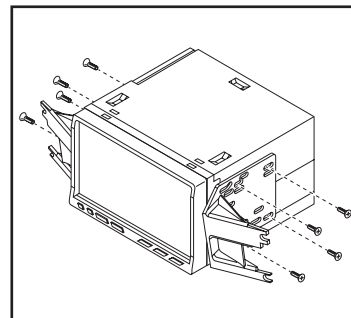

(Figure A)

AXXESS INTERFACE INSTALLATION

INTERFACE FEATURES

- Provides NAV outputs (parking brake, reverse, speed sense)
- Retains audio controls on the steering wheel
- Retains the factory backup camera
- Includes an AX-CAM6V 12-to-6V step-down for the factory camera
- Retains the factory AUX-IN jack
- Retains balance
- Micro-B USB updatable

INTERFACE COMPONENTS

- Axxess interface
- AX-HYKIA-SPDIF interface
- AX-CAM6V
- 7388 wiring harness (a) (labeled LD-SOULAMP)
- 7388 wiring harness (b) (labeled LD-SOULAMP2)
- 16-pin harness with stripped leads
- Female 3.5mm connector with stripped leads

TABLE OF CONTENTS

Connections.....	5-6
Installing the Axxess Interface and AX-HYKIA-SPDIF	6
Programming the Axxess Interface and Climate Display	7
Final Assembly	7
Audio Level Adjustment	7
Steering Wheel Control Settings	8-11
- LED feedback	
- Changing radio type	
- Remapping the steering wheel control buttons	
- Dual assignment instructions (long button press)	
Troubleshooting.....	11

TOOLS REQUIRED

- Crimping tool and connectors, or solder gun, solder, and heat shrink
- Tape • Wire cutter • Zip ties • Small flat-blade screwdriver

CONNECTIONS

From the 16-pin harness with stripped leads to the aftermarket radio:

- Connect the **Red** wire to the accessory wire.
- Connect the **Blue/White** wire to the amp turn on wire. This wire must be connected to hear sound from the factory amplifier.
- Connect the **Gray** wire to the right front positive speaker output.
- Connect the **Gray/Black** wire to the right front negative speaker output.
- Connect the **White** wire to the left front positive speaker output.
- Connect the **White/Black** wire to the left front negative speaker output.
- Tape off and disregard the following (9) wires, they will not be used in this application: **Blue/Pink, Brown, Green, Green/Black, Green/Purple, Light Green, Orange/White, Purple, Purple/Black**

From the 7388 harness to the aftermarket radio:

There are (2) 7388 harnesses. Harness (a) is for 2018-up models, and harness (b) is for 2017 models.

- Connect the **Black** wire to the ground wire, and also to the **Black** wire from the AX-CAM6V.
Note: For harness (a) only, connect the **Black** wire labeled “CAMERA GROUND” as well.
- Connect the **Yellow** wire to the battery wire.
- Connect the **Red** wire labeled “6-volt camera power” to the **Blue/Red** wire from the AX-CAM6V.
- Connect the **Blue** wire to the power antenna wire.
- If the aftermarket radio has an illumination wire, connect the **Orange** wire to it.

The following (3) wires are only for multimedia/navigation radios that require these wires.

- Connect the **Blue/Pink** wire to the speed sense wire.
- Connect the **Green/Purple** wire to the reverse wire, and also to the **Blue/White** wire from the AX-CAM6V.
- Connect the **Light Green** wire to the parking brake wire.
- If retaining the factory AUX-IN jack, connect the **Red** and **White** RCA jacks to the audio AUX-IN jacks.
- Connect the **Yellow** RCA jack to the backup camera input.

CONNECTIONS (CONT.)

3.5mm jack steering wheel control retention:

The 3.5mm jack is to be used to retain audio controls on the steering wheel.

- **For the radios listed below:** Connect the *female 3.5mm connector with stripped leads*, to the male 3.5mm SWC jack from the 7388 harness. Any remaining wires tape off and disregard:
 - **Eclipse:** Connect the steering wheel control wire, normally **Brown**, to the **Brown/White** wire from the connector. Then connect the remaining steering wheel control wire, normally **Brown/White**, to the **Brown** wire from the connector.
 - **Metra OE:** Connect the steering wheel control Key 1 wire (**Gray**) to the **Brown** wire.
 - **Kenwood or select JVC with a steering wheel control wire:** Connect the **Blue/Yellow** wire to the **Brown** wire.

Note: If the **Kenwood** radio auto detects as a **JVC**, manually set the radio type to **Kenwood**. See the instructions under **Changing Radio Type**.

- **XITE:** Connect the steering wheel control SWC-2 wire from the radio to the **Brown** wire.
- **Parrot Asteroid Smart or Tablet:** Connect the 3.5mm jack into the AX-SWC-PARROT (sold separately), and then connect the 4-pin connector from the AX-SWC-PARROT into the radio.

Note: The radio must have rev. 2.1.4 or higher software.
- **Universal “2 or 3 wire” radio:** Connect the steering wheel control wire, referred to as Key-A or SWC-1, to the **Brown** wire from the connector. Then connect the remaining steering wheel control wire, referred to as Key-B or SWC-2, to the **Brown/White** wire from the connector. If the radio comes with a third wire for ground, disregard this wire. **Note:** After the interface has been programmed to the vehicle, refer to the manual provided with the radio for assigning the SWC buttons. Contact the radio manufacturer for more information.
- **For all other radios:** Connect the 3.5mm jack from the 7388 harness into the jack from the aftermarket radio designated for an external steering wheel control interface. Please refer to the aftermarket radios manual if in doubt as to where the 3.5mm jack should connect to.

INSTALLATION

Installing the Axxess interface and AX-HYKIA-SPDIF

With the key in the off position:

1. Connect the *16-pin harness with stripped leads*, and the *7388 harness*, into the Axxess interface.
2. Connect the *7388 harness* to the AX-HYKIA-SPDIF interface.
3. Connect the *7388 harness* to the *climate display*.
4. Locate the factory antenna connector in the dash and complete all necessary connections to the radio. Use the antenna adapter provided to adapt the factory antenna connector to the aftermarket radio.

Attention! If retaining steering wheel controls, ensure that the SWC jack/wire is connected to the radio before proceeding. If this step is skipped, the interface will need to be reset for the steering wheel controls to function.

PROGRAMMING THE AXCESS INTERFACE AND CLIMATE DISPLAY

Programming the Axxess interface:

1. For the steps below, the LED located inside the interface can only be seen while active. The interface does not need to be opened to see the LED.
2. Start the vehicle. The LED will initially turn on solid **Green**, then turn off for a few seconds while it auto detects the radio installed.
3. The LED will then flash **Red** up to (24) times indicating which radio is connected to the interface, and then turn off for a couple of seconds. Pay close attention to how many **Red** flashes there are. This will help in troubleshooting, if need be. Refer to the LED feedback section for more information.
4. After a couple seconds the LED will turn on solid **Red** while the interface auto detects the vehicle. The radio will shut off at this point. This process should take 5 to 30 seconds.
5. Once the vehicle has been auto detected by the interface, the LED will turn on solid **Green**, and the radio will come back on, indicating programming was successful.

Programming the climate display:

1. Turn the parking lights on.
2. Turn the vehicles light dimmer all the way down, then all the way up.
3. Turn the lights off.
4. Test all functions of the installation for proper operation before reassembling the dash. Refer to the **Steering Wheel Control Settings** section for customizing the buttons, if so desired. Refer also to the **Audio Level Adjustment** section for adjusting the amplifier gain, if need be.

FINAL ASSEMBLY

1. Secure the radio assembly to the dash using the factory screws.
2. Reassemble the dash in reverse order of disassembly to complete the installation.

AUDIO LEVEL ADJUSTMENT

1. With the vehicle and radio turned on, turn the volume up 3/4 of the way.
2. With a small flat-blade screwdriver, adjust the potentiometer clockwise to raise the audio level; counterclockwise to lower the audio level.
3. Once at a desired level, audio level adjustment is complete.

STEERING WHEEL CONTROL SETTINGS

L.E.D. Feedback: The (26) **Red L.E.D.** flashes represent a different radio manufacturer for the **SWC interface** to detect. For example, if you are installing a **JVC** radio, the **SWC interface** will flash **Red** (5) times, then stop. Following is the **L.E.D Feedback Legend**, which indicates the flash count of the radio manufacturer.

RADIO	LED PATTERN
PIONEER/JENSEN	G
JVC	R
KENWOOD	GG
SONY/DUAL	GR
Reserved for future use	RG
ALPINE	RR
ALPINE (type 2)	GGG
AXXERA	GGR
AXXERA (type 2)	GRG
MAGNADYNE	GRR

- 1) If the LED pattern shows **JVC**, but a **JVC** radio isn't installed, change the radio type to Kenwood. Refer to the **Changing Radio Type** document.
- 2) If the LED pattern shows **Alpine**, but an **Alpine** radio isn't installed, make sure the 3.5mm jack is plugged into the radio.
- 3) If no SWC, change the radio type to the opposite radio type. Refer to the **Changing Radio Type** document
- 4) **AX-SWC-PARROT** required (sold separately). The software in the radio must be rev. 2.1.4 or higher.

Continued on the next page

RADIO	LED PATTERN
BOSS	RGG
Reserved for future use	RGR
CLARION (type 1)	RRG
CLARION (type 2)	RRR
Reserved for future use	GGGG
Reserved for future use	GGGR
Reserved for future use	GGRG
Reserved for future use	GRRR
Reserved for future use	GRGG
Reserved for future use	GRGR
Resistive Radio #1	GRRG
Resistive Radio #2	GRRR
Resistive Radio #3	RGGG
Resistive Radio #4	RGGR
Resistive Radio #5	RGRG
Resistive Radio #6	RRRR

STEERING WHEEL CONTROL SETTINGS (CONT.)

Changing radio type

If the LED flashes do not match the radio you have connected, you must manually program the Axxess interface to tell it what radio it is connected to.

1. After (3) seconds of turning the key on, press and hold the **Volume Down** button on the steering wheel until the LED in the Axxess interface goes solid.
2. Release the **Volume Down** button; the LED will go out indicating the Axxess interface is in **Changing Radio Type** mode.
3. Refer to the **Radio Legend** to know which radio number you would like to have programmed.
4. Press and hold the **Volume Up** button until the LED goes solid, and then release. Repeat this step for the desired radio number you have selected.
5. Once the desired radio number has been selected, press and hold the **Volume Down** button on the steering wheel until the LED goes solid. The LED will remain on for about (3) seconds while it stores the new radio information.
6. Once the LED goes out, the **Changing Radio Type** mode will then end. You can now test the steering control wheel controls.

Note: If at any time the user fails to press any button for a period longer than (10) seconds, this process will abort.

Radio Legend

1. Pioneer/Jensen	8. Axxera	15. Reserved	22. Resitive Radio #2
2. JVC	9. Axxera (Type 2)	16. Reserved	23. Resitive Radio #3
3. Kenwood	10. Magnadyne	17. Reserved	24. Resitive Radio #4
4. Sony/Dual	11. Boss	18. Reserved	25. Resitive Radio #5
5. Reserved	12. Reserved	19. Reserved	26. Resitive Radio #6
6. Alpine	13. Clarion (Type 1)	20. Reserved	
7. Alpine (Type 2)	14. Clarion (Type 2)	21. Resitive Radio #1	

Continued on the next page

STEERING WHEEL CONTROL SETTINGS (CONT.)

Remapping the steering wheel control buttons

Once the Axxess interface has been programmed, the button assignment for the steering wheel controls may be reassigned if so desired. For example, if the **Seek Up** button is preferred to be the **Mute** button instead. Follow the steps below to remap the steering wheel control buttons.

1. Ensure the Axxess interface is visible so you can see the LED flashes to confirm button recognition.

Tip: Turning the radio off is recommended.

2. Within the first twenty seconds of turning the ignition on, press and hold the **Volume Up** button on the steering wheel until the LED goes solid.
3. Release the **Volume Up** button, the LED will then go out; The **Volume Up** button has now been programmed.
4. Follow the list in the **Button Function Legend** to reference the order in which the steering wheel control buttons need to be programmed.

Note: If the next function on the list is not on the steering wheel, press the **Volume Up** button for (1) second until the LED comes on to skip that function, and then release the **Volume Up** button. This will tell the Axxess interface that this function is not available, and it will move on to the next function.

5. To complete the remapping process, press and hold the **Volume Up** button until the LED in the Axxess interface goes out.

Button Function Legend

1. Volume-Up	7. Preset-Up	13. On-Hook
2. Volume-Down	8. Preset-Down	14. Off-Hook
3. Seek-Up/Next	9. Power	15. Fan-Up *
4. Seek-Down/Prev	10. Band	16. Fan-Down *
5. Source/Mode	11. Play/Enter	17. Temp-Up *
6. Mute	12. PTT (Push to Talk)	18. Temp-Down *

* Not applicable in this application

Note: Some radios may not have these commands. Please refer to the manual provided with the radio, or contact the radio manufacturer for specific commands recognized by that particular radio.

Continued on the next page

STEERING WHEEL CONTROL SETTINGS (CONT.)

Dual assignment instructions (long button press)

The Axxess interface has the capability to assign (2) functions to a single button, except **Volume Up** and **Volume Down**. Follow the steps below to program the button(s) to the desired setting.

Note: **Seek Up** and **Seek Down** come pre-programmed as **Preset Up** and **Preset Down** for a long button press.

1. Turn the key to ignition but do not start the vehicle.
2. Press and hold the desired steering wheel control button for (10) seconds, or until the LED flashes rapidly. At this point release the button; the LED will then go solid.
3. Press and release the **Volume Up** button the number of times corresponding to the new button number selected. Refer to the **Dual Assignment Legend**. The LED will flash rapidly while the **Volume Up** button is being pressed, and then go back to a solid LED once released. Proceed to the next step once the **Volume Up** button has been pressed the desired number of times.

Caution: If more than (10) seconds elapses between pressing the **Volume Up** button, this procedure will abort, and the LED will go out.

4. Press the desired button to store it to memory. The LED will now go out indicating the new information has been stored to memory.

Note: These steps must be repeated for each button desired to assign a dual assignment feature to. To reset a button back to its default state, repeat Step 1, then press the **Volume Down** button. The LED will go out, and the dual assignment feature for that button will be erased.

Dual Assignment legend

- | | | |
|-------------------|------------------------|-----------------|
| 1. Not allowed | 7. Preset-Up | 13. On-Hook |
| 2. Not allowed | 8. Preset-Down | 14. Off-Hook |
| 3. Seek-Up/Next | 9. Power | 15. Fan-Up * |
| 4. Seek-Down/Prev | 10. Band | 16. Fan-Down * |
| 5. Mode/Source | 11. Play/Enter | 17. Temp-Up * |
| 6. ATT/Mute | 12. PTT (Push to Talk) | 18. Temp-Down * |

* Not applicable in this application

TROUBLESHOOTING

Resetting the Axxess interface

1. The **Blue** reset button is located inside the Axxess interface, between the two connectors. The button is accessible outside the Axxess interface, no need to open the Axxess interface.
2. Press and hold the reset button for (2) seconds, then let go to reset the Axxess interface.
3. Refer to **Programming the Axxess Interface** from this point.



99-7388HG
INSTALLATION INSTRUCTIONS



Having difficulties? We're here to help.



Contact our Tech Support line at:

386-257-1187



Or via email at:

techsupport@metra-autosound.com

Tech Support Hours (Eastern Standard Time)

Monday - Friday: 9:00 AM - 7:00 PM

Saturday: 10:00 AM - 5:00 PM

Sunday: 10:00 AM - 4:00 PM



**Metra recommends MECP
certified technicians**