



Fits Jeep Wrangler JK 2011-2018

Visit MetraOnline.com for more detailed information about the product and up-to-date vehicle specific applications

KIT FEATURES

- Full dash panel is designed to replace the factory dash panel and allow for the installation of a standard 4" tall aftermarket radio or ISO Single-DIN radio provision with pocket (88-00-9004 sold separately)
- Textured to match the factory finish
- No custom fabrication work is required
- Made from the highest quality ABS plastic for an original factory-like fit and finish

KIT COMPONENTS

- A) Radio trim panel • B) Dash panel • C) Radio brackets • D) Pocket • E) Vent sub bracket • F) Top sub bracket • G) 11-14 trim panel
• H) 15-18 trim panel • I) Phillips screws (6) • J) Panel clips (15)

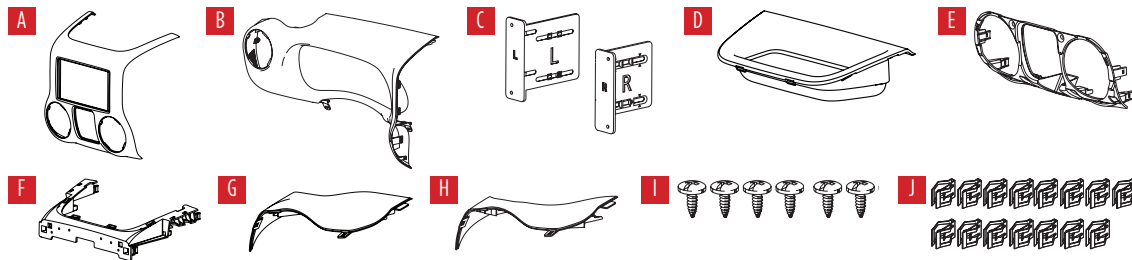

TABLE OF CONTENTS

Dash Disassembly	2
Kit Preparation.....	3-5
Kit Assembly	5

WIRING & ANTENNA CONNECTIONS (sold separately)

See axessinterface.com for A/V and SWC interface options.

Antenna Adapter: 40-EU10

TOOLS REQUIRED

- Panel removal tool • Phillips screwdriver
- Socket wrench

Attention! With the key out of the ignition, disconnect the negative battery terminal before installing this product. Ensure that all installation connections are secure before cycling the ignition to test this product.

DASH DISASSEMBLY

(modifications to radio cavity required)

1. Unclip and remove the power window switches then remove (1) 9/32" screw from underneath. (Figure A)
2. Unclip and remove the panel below the steering column.
3. Remove (2) 9/32" screws from the bottom edge of the radio/instrument cluster trim panel on either side of the steering column. (Figure B, C)
4. Remove pad in pocket on top center of dash then remove (1) 9/32" screw underneath. Remove dash panel from around radio and instrument cluster. (Figure D)

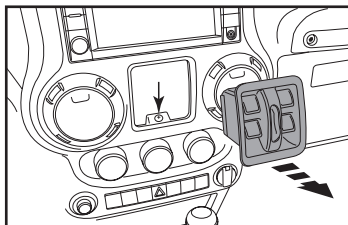

(Figure A)

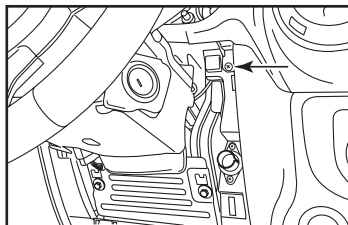

(Figure B)

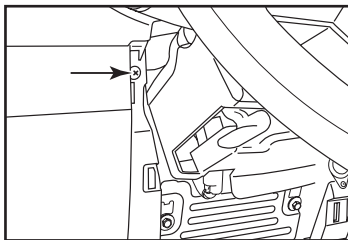

(Figure C)

5. Remove (4) 9/32" screws securing the radio. Unplug and remove radio.
6. Remove (2) 9/32" screws securing the metal bracket inside of the dash cavity and remove it for depth. (Figure E)
7. A small cut in the plastic at the top of the radio cavity will be required for most double DIN radios. (Figure F)
8. Press down on the tab located on the back and top of the vent, then rotate a quarter turn to remove the factory vents from the dash panel and set them aside for kit assembly.

Continue to Kit Preparation

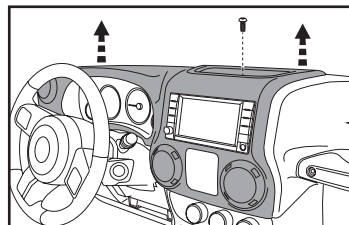

(Figure D)

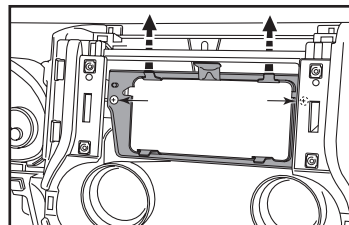

(Figure E)

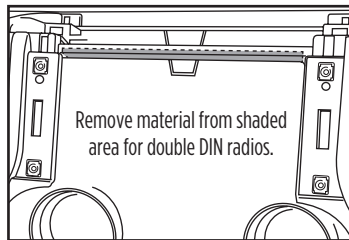

(Figure F)

KIT PREPARATION

1. Attach (3) supplied **panel clips** to the dash panel. (Figure A)
2. Attach (6) supplied **panel clips** to the **vent sub bracket** and attach to the **radio trim panel** using (4) of the supplied screws. (Figures B)

Continue to Kit Assembly

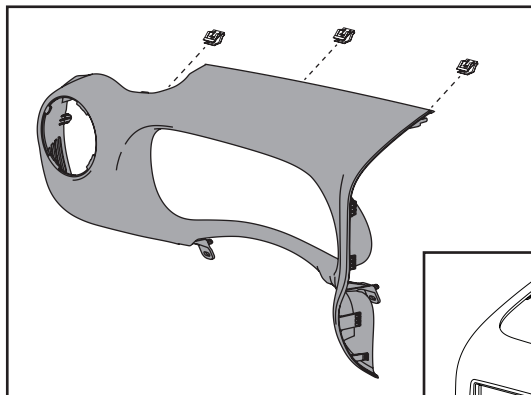

(Figure A)

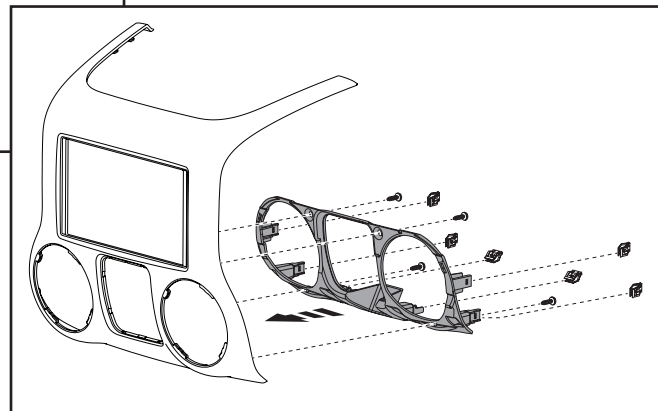

(Figure B)

KIT PREPARATION (CONT.)

3. Attach (4) supplied **panel clips** to the **top sub bracket** and attach to the **radio trim panel** using (2) of the supplied screws. Be sure to slide the bracket onto the upper alignment tabs and slide into place before using the (2) screws. (Figures C, D and Detail)

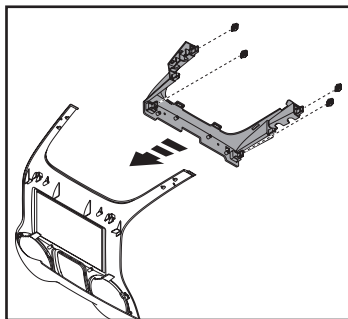

(Figure C)

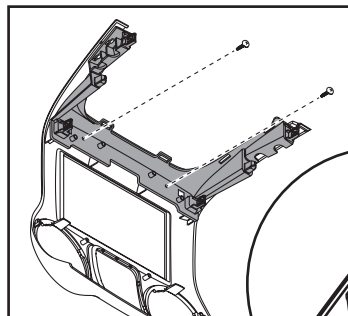

(Figure D)

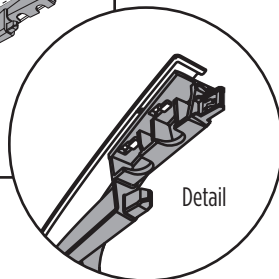

4. Select the appropriate year **trim panel**, snap it to the **radio trim panel** and attach (2) supplied **panel clips**. (Figures E, F)

Continued on the next page

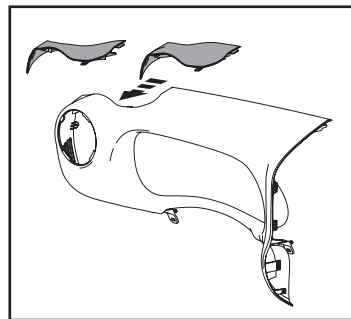

(Figure E)

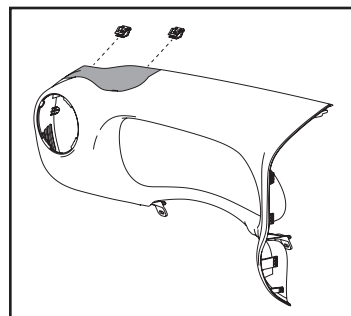

(Figure F)

KIT PREPARATION (CONT.)

5. Insert the factory vents into the **radio trim panel** from the front and rotate counter clockwise a quarter turn to lock into place. (Figure G)
6. Snap the **pocket** into the top of the **radio trim panel**. (Figure H)

Continue to Kit Assembly

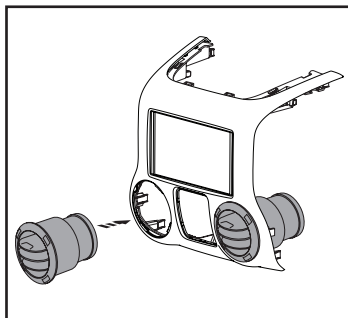

(Figure G)

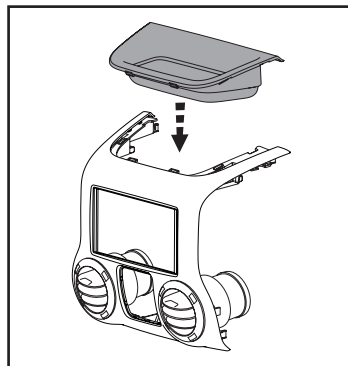

(Figure H)

KIT ASSEMBLY

1. Attach the **radio brackets** to the radio using screws supplied with the radio. (Figure A)
2. Locate the factory wiring harness and antenna connector in the dash, and complete all necessary connections to the radio. Metra recommends using the proper mating adapter from Metra and/or AXXESS. Re-connect the negative battery terminal and test the radio for proper operation.
3. Secure the radio assembly into the dash opening.
4. Secure the **dash panel** to the dash.
5. Snap the **radio trim panel** over the radio and secure with one factory screw.
6. Reassemble the dash in reverse order of disassembly.

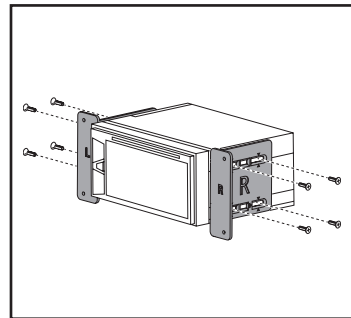

(Figure A)

[illegible]



DP-6511-JK

INSTALLATION INSTRUCTIONS



Having difficulties? We're here to help.



Contact our Tech Support line at:

386-257-1187



Or via email at:

techsupport@metra-autosound.com

Tech Support Hours (Eastern Standard Time)

Monday - Friday: 9:00 AM - 7:00 PM

Saturday: 10:00 AM - 5:00 PM

Sunday: 10:00 AM - 4:00 PM



**Metra recommends MECP
certified technicians**