



Fits Jeep Wrangler JK 2007-2010

Visit MetraOnline.com for more detailed information about the product and up-to-date vehicle specific applications

KIT FEATURES

- DDIN radio provision
- ISO DIN radio provision with pocket sold separately (88-00-9004)
- Housings are included for models with 2 or 4 power windows, and a blank plate for models without
- Textured to match the factory finish

KIT COMPONENTS

- A) Radio trim panel • B) Radio brackets • C) Window switch trim panel (2-window, 4-window, blank plate) • D) Phillips screws (4) • E) Panel clips (4)

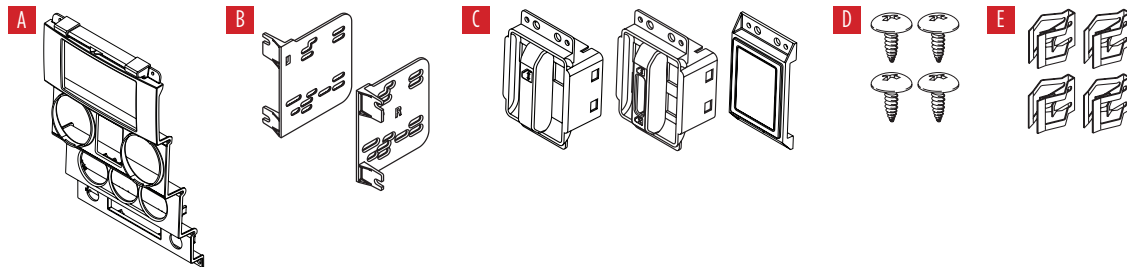

TABLE OF CONTENTS

Dash Disassembly	2
Kit Preparation	3-5
Kit Assembly	6

WIRING & ANTENNA CONNECTIONS

Wiring Harness: See axxessinterface.com for A/V and SWC interface options.
Antenna Adapter: 40-EU10

TOOLS REQUIRED

- Panel removal tool • Phillips screwdriver
- Socket wrench

Attention! With the key out of the ignition, disconnect the negative battery terminal before installing this product. Ensure that all installation connections are secure before cycling the ignition to test this product.

DASH DISASSEMBLY

1. Unclip and remove the lower center trim below A/C controls. (Figure A)
2. Remove (2) Phillips screws exposed behind lower center panel. (Figure B)
3. Unclip and remove the upper center trim starting towards the rear of the panel. (Figure C)
4. Remove (2) Phillips screws exposed behind upper center panel. (Figure D)

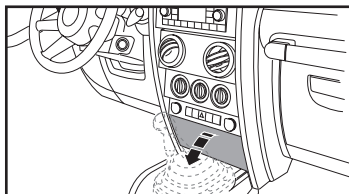

(Figure A)

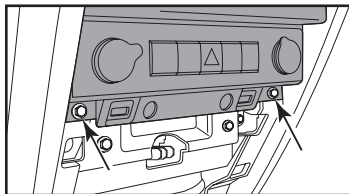

(Figure B)

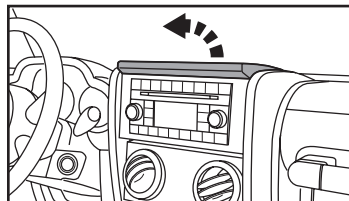

(Figure C)

5. Unclip and remove entire panel surrounding radio and climate controls, including A/C vents. (Figure E)
6. Remove (4) 7mm screws securing radio. Unplug and remove radio. (Figure F)

Note: The top of the metal bracket in the sub dash will need to be cut to allow for the clearance of the Double DIN radio's chassis. (Figure F)

Continue to Kit Preparation

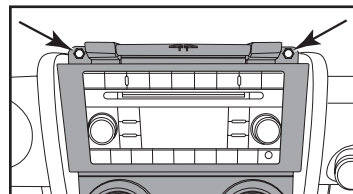

(Figure D)

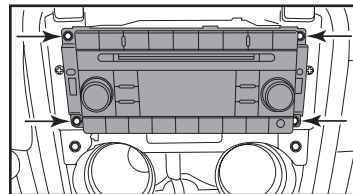

(Figure E)

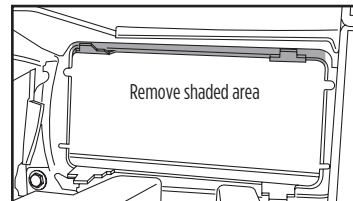

(Figure F)

KIT PREPARATION

From the factory dash panel:

1. Turn the A/C vents clockwise to unlock and remove them. (Figure A)
2. Unclip the power window switch (if applicable).
3. Remove the factory climate control and hazard button panel. (Figure B)
4. Remove the hazard button panel and the power outlets. (Figure C)

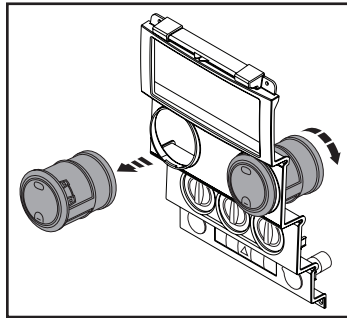

(Figure A)

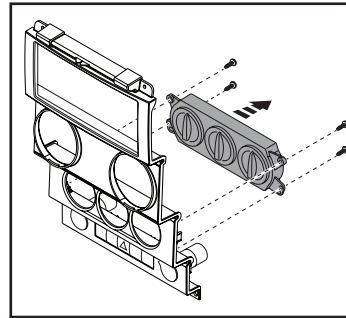

(Figure B)

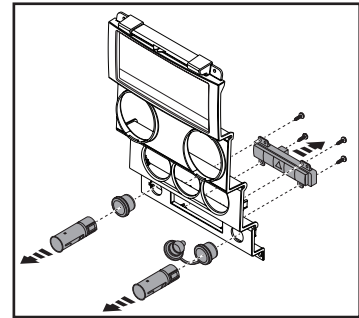

(Figure C)

Continued on the next page

KIT PREPARATION (CONT.)

To the DP-6510-JK dash panel:

1. Snap the power window switch (if applicable) into the appropriate window switch trim panel. (four-button switch shown) (Figure A)
2. Secure the switch assembly or blank plate to the radio trim panel using the supplied screws. (Figure B)

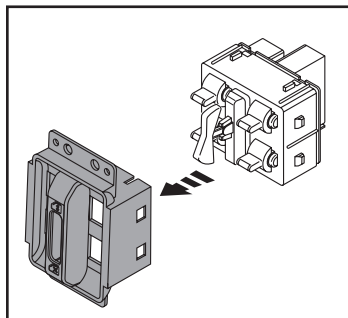

(Figure A)

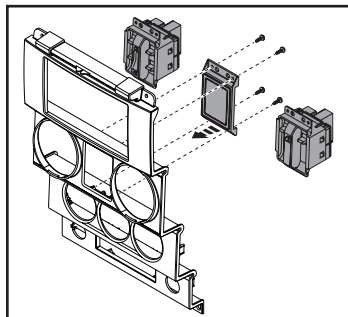

(Figure B)

3. Install the hazard button panel and the power outlets using the factory hardware. (Figure C)
4. Install the climate control using the factory hardware. (Figure D)

Continued on the next page

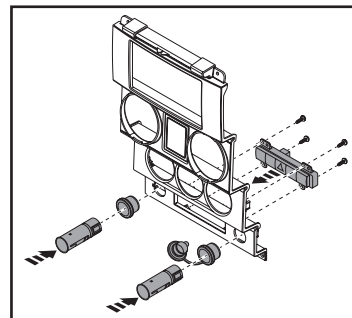

(Figure C)

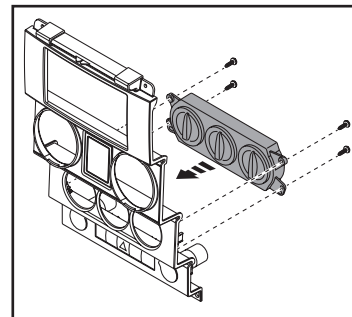

(Figure D)

KIT PREPARATION (CONT.)

1. Install the A/C vents, turn the vents counter-clockwise to lock them into the **radio trim panel**. (Figure A)
2. Attach the (4) supplied **panel clips** to the **radio trim panel**. (Figure B)

Continue to Kit Assembly

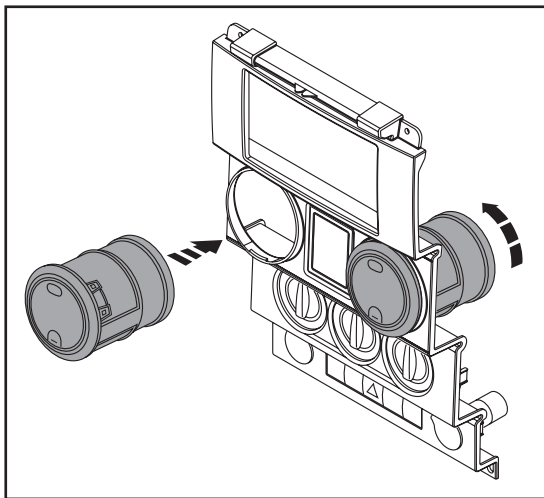

(Figure A)

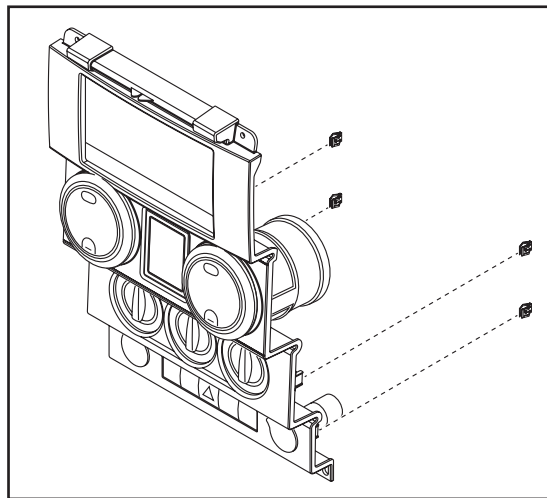

(Figure B)

KIT ASSEMBLY

1. Attach the **radio brackets** to the radio using screws supplied with the radio. (Figure A)
2. Locate the factory wiring harness and antenna connector in the dash, and complete all necessary connections to the radio. Metra recommends using the proper mating adapter from Metra and/or AXXESS. Re-connect the negative battery terminal and test the radio for proper operation.
3. Secure the radio/bracket assembly into the dash opening using the factory hardware. Snap the **radio trim panel** over the radio and reassemble the dash in reverse order of disassembly.

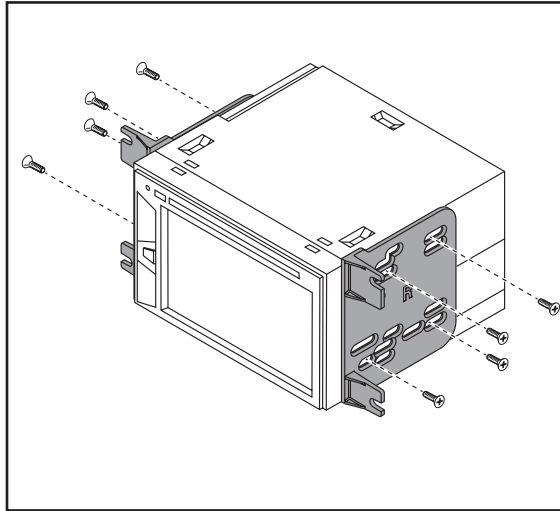

(Figure A)

[illegible]



DP-6510-JK

INSTALLATION INSTRUCTIONS



Having difficulties? We're here to help.



Contact our Tech Support line at:

386-257-1187



Or via email at:

techsupport@metra-autosound.com

Tech Support Hours (Eastern Standard Time)

Monday - Friday: 9:00 AM - 7:00 PM

Saturday: 10:00 AM - 5:00 PM

Sunday: 10:00 AM - 4:00 PM



**Metra recommends MECP
certified technicians**